

Scale 1:250 - Lengths are in Metres.

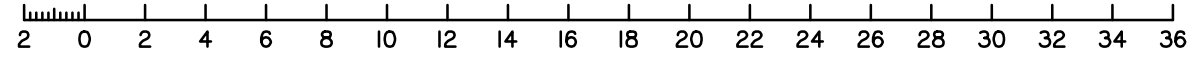

DISCLOSURE PLAN FOR PROPOSED ALLOTMENT 42 Dated 8th February 2022

This plan shows details of proposed allotment 42 on the Proposal Plan BUN-005 Rev C dated 15th October 2021 lodged as part of a Subdivision Application with Sunshine Coast Regional Council, subject to conditions.

The area being proposed allotment 42 described as part of Lots 37, 45 & 46 on RP43331, and situated at Bunya Street, Maleny.

The allotment contains an area of 800 square metres, more or less.

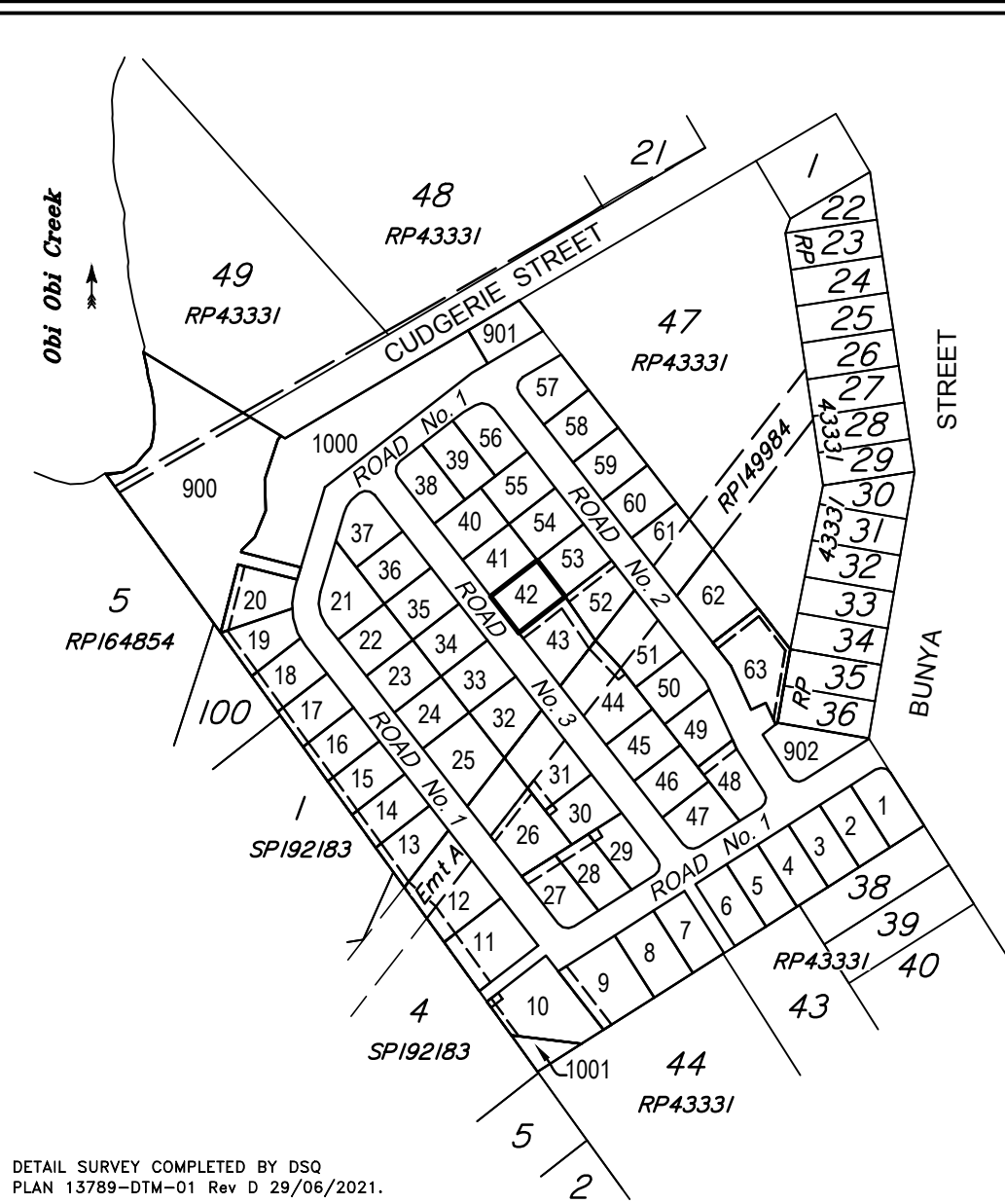

Scale 1:4000 - Lengths are in Metres.

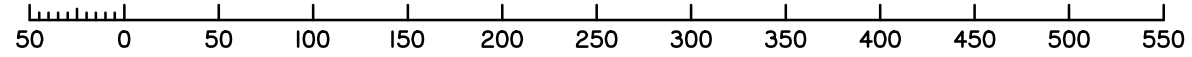

DETAIL SURVEY COMPLETED BY DSQ
PLAN 13789-DTM-01 Rev D 29/06/2021.
ENGINEERING DESIGN BY WALSH
CONSULTING ENGINEERS PLANS C6289
DATED 27/01/2022.

THE
ENCLAVE
Maleny

Disclosure Plan
BUNYA ST, MALENY
PROPOSED LOT 42

ALL FILL WITHIN ALLOTMENTS IS TO LEVEL 1 INSPECTION AND TESTING IN ACCORDANCE WITH AS3798-2007

- FILL AREAS SHOWN THUS
- CUT AREAS SHOWN THUS
- BUILDING EXCLUSION ZONE
- EDGE OF BATTER
- RETAINING WALL
- RETAINING WALL HEIGHT
- EXISTING SURFACE CONTOURS
- CUT HEIGHT
- FILL HEIGHT

Note
Contour interval is shown at 0.5 metres.

Revisions	Surveyed	Drawn	Checked	Passed	Date	
A	ORIGINAL PLAN	DSQ	JJ	AJP	AJP	08.02.22

DSQ
LAND SURVEYORS
SUNSHINE COAST
PO Box 1073, Buddina QLD 4575 Ph: (07) 5437 8555
mail@dsqsurvey.com ABN: 91 615 043 251
www.dsqsurvey.com ACN: 615 043 251
WESTERN DOWNS

Signed
Cadastral Surveyor/Director
Date **8/02/2022**

Horiz. Datum MGA2020 Z56 Vert. Datum AHD
Origin PSM 132696 Origin PSM 132696
RL 417.192

Locality: MALENY
Local Government: SUNSHINE COAST REGIONAL COUNCIL

SHEET 1 OF 1 Scale At A3 size
COMPUTER FILE 13789 DIS 02 Rev A

DRAWING NUMBER **13789 DIS-42** REV. **A**

2022/02/09W:\DSQ_Data\Jobs Current\13789 RM Developments (Maleny)\Data Survey\Disclosures\13789 DIS 02 Rev A.dwg